

## LED MR16 LAMP

7W GU5.3/7W GU10/7.5W GU10/9W GU10

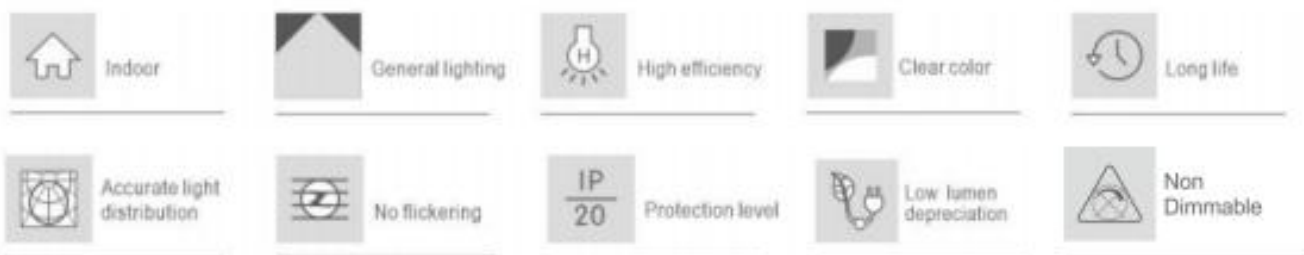

COLOUR: WHITE



## Features

- High Quality Ultra Bright LED Bulbs
- Up to 90% Energy Saving, 50000 Hours Lifetime
- Ultra low power consumption
- Cheap to run (save electricity)
- Great reducing carbon emission, environmentally friendly.
- Solid state, shockproof.
- Spotlight, no VU and IR radiation.

## Application

including home, shop window, showcase, studio, other indoor lighting, etc.





## Size Diagram

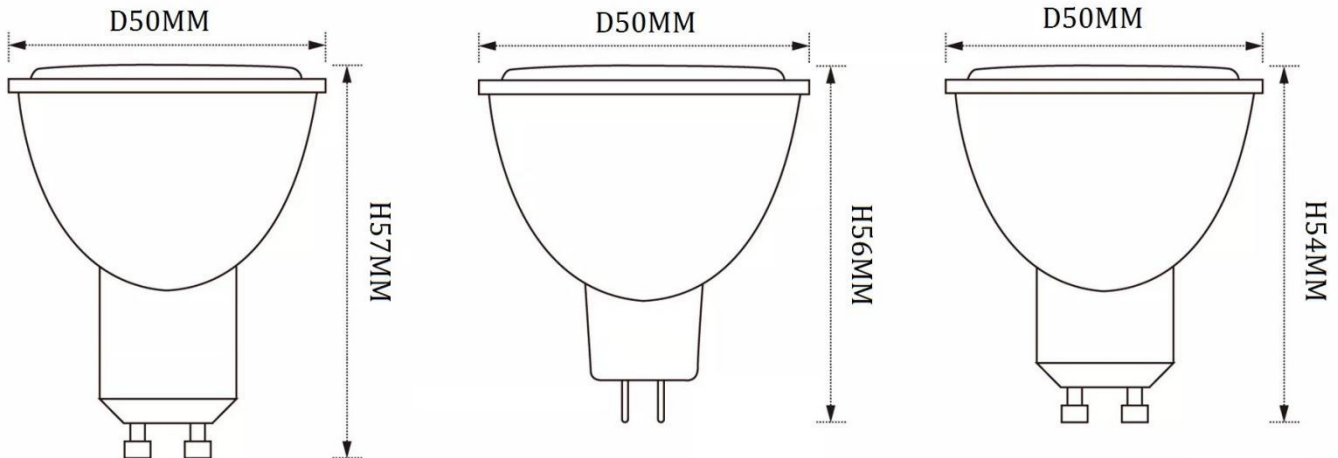

GU5.3



GU10



No Flicker



Ra80



15000  
-25000h



AC100-240V



For Indoor



38°/60°



0.5

## A variety of color temperature options



3000K



4000K



6500K

## Product Parameter

Item No.	CCT	Watt	Size(cm)	Description
7W GU5.3	3000K	6.3-6.5W	5*5*5.6	7pcs LED Chip(Bridgelux), Non-isolated Driver, warranty for 2 years, Material: PC, Lumen: 80-90LM/W, Voltage: 100-240V, CRI:80RA
7W GU5.3	4000K	6.3-6.5W	5*5*5.6	
7W GU5.3	6500K	6.3-6.5W	5*5*5.6	
7-7.5W GU10	3000K	7-7.5W	5*5*5.4	10pcs LED Chip(Bridgelux), Non-isolated Driver, warranty for 3 years, Material: PC, Lumen: 90-100LM/W, Voltage: 100-240V, CRI:80RA
7-7.5W GU10	4000K	7-7.5W	5*5*5.4	
7-7.5W GU10	6500K	7-7.5W	5*5*5.4	
9W GU10	3000K	8.5-8.8W	5*5*7	10pcs LED Chip(Bridgelux), Non-isolated Driver, warranty for 3 years, Material: PC, Lumen: 90-100LM/W, Voltage: 100-240V, CRI:80RA
9W GU10	4000K	8.5-8.8W	5*5*7	
9W GU10	6500K	8.5-8.8W	5*5*7	

## Light Distribution

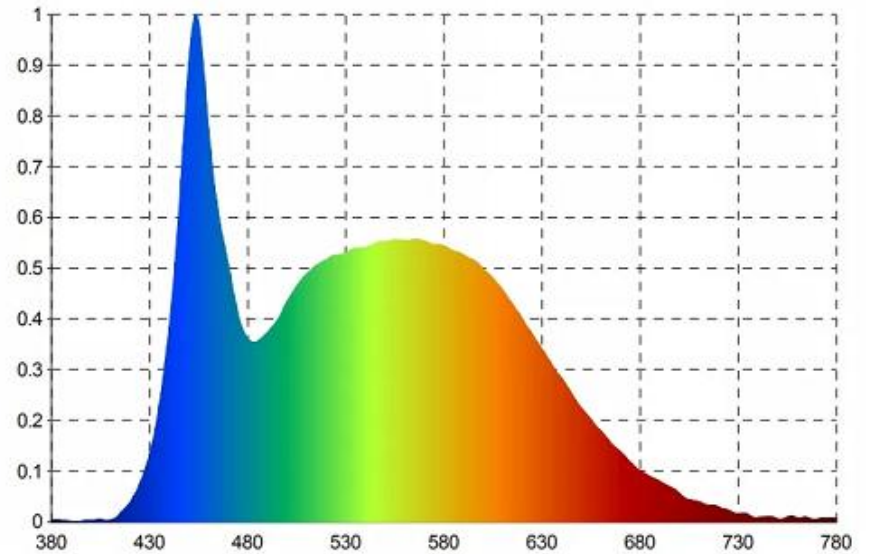
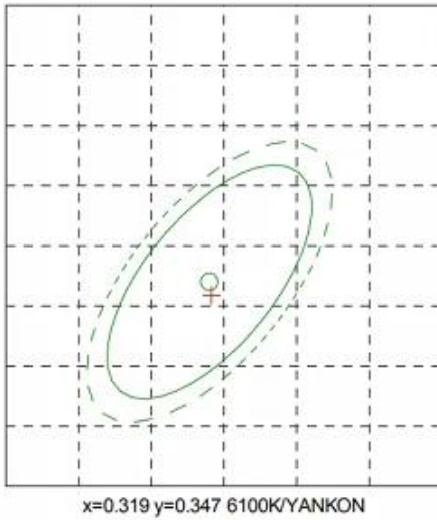

## Package Information

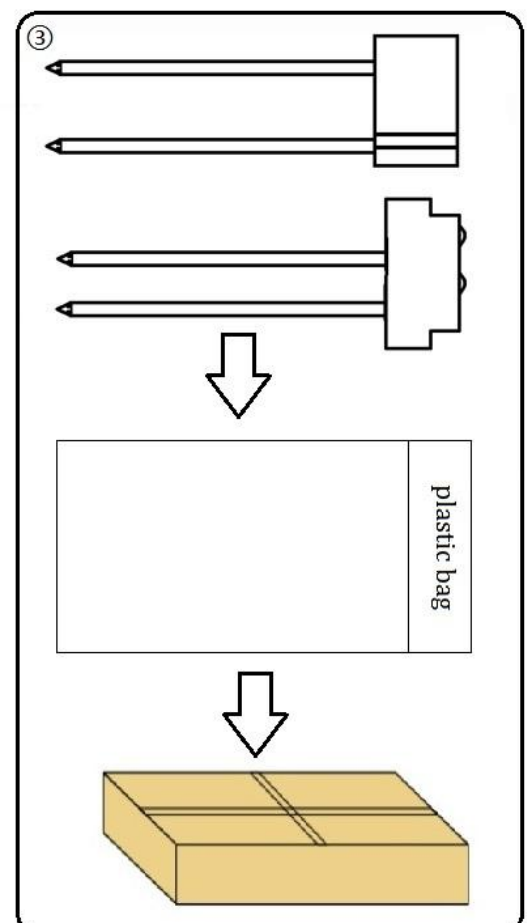
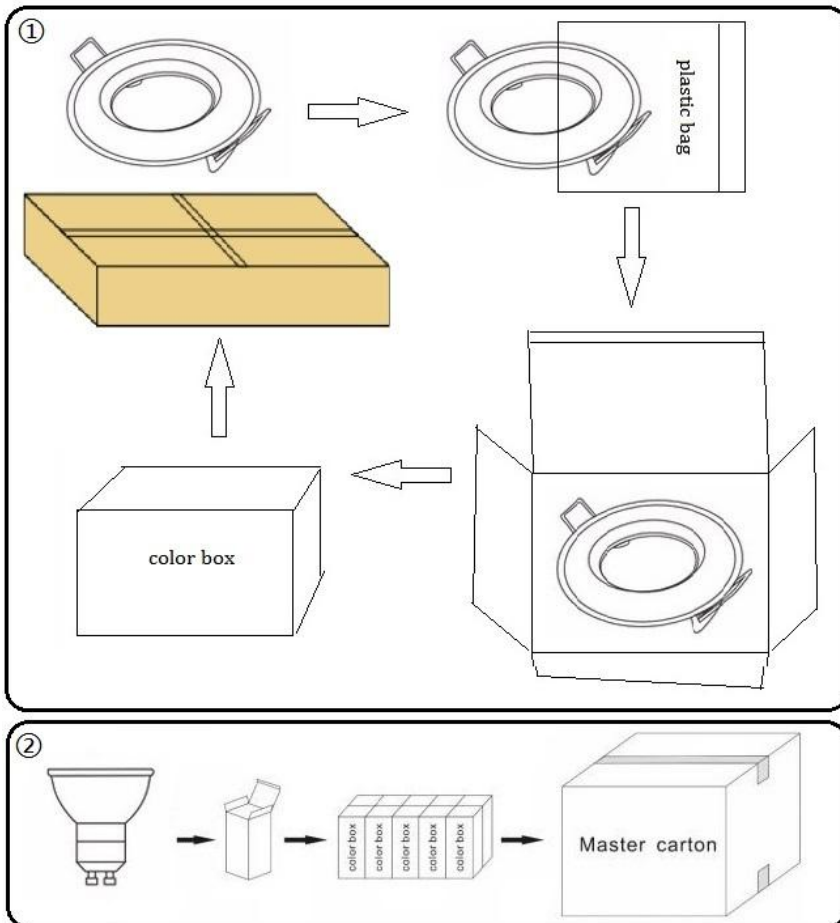

- ① 1pcs housing with bag pack in 1 color box, 50-100 boxes pack in 1 carton.
- ② 1pcs lamp pack a color box, 10 boxes in a bag, 200 boxes pack in 1 carton.
- ③ 500pcs pack in a bag, 1000pcs-4000pcs pack in 1 carton.

## ADAPTER

MR16/GU5.3/GU10



MR16



GU5.3



GU10



## Product Parameter

Item No	Wire Size(mm)	Application
MR16	0.75mm*L150	Connect LED MR16 Lamp
GU5.3	0.75mm*L150	Connect LED MR16 Lamp
GU10	0.75mm*L150	Connect LED MR16 Lamp
MR16-GU10	/	MR16→GU10, Connect LED MR16 Lamp
GU5.3-GU10	/	GU5.3→GU10, Connect LED MR16 Lamp
GU10-MR16	/	GU10→MR16, Connect LED MR16 Lamp

## Size Diagram

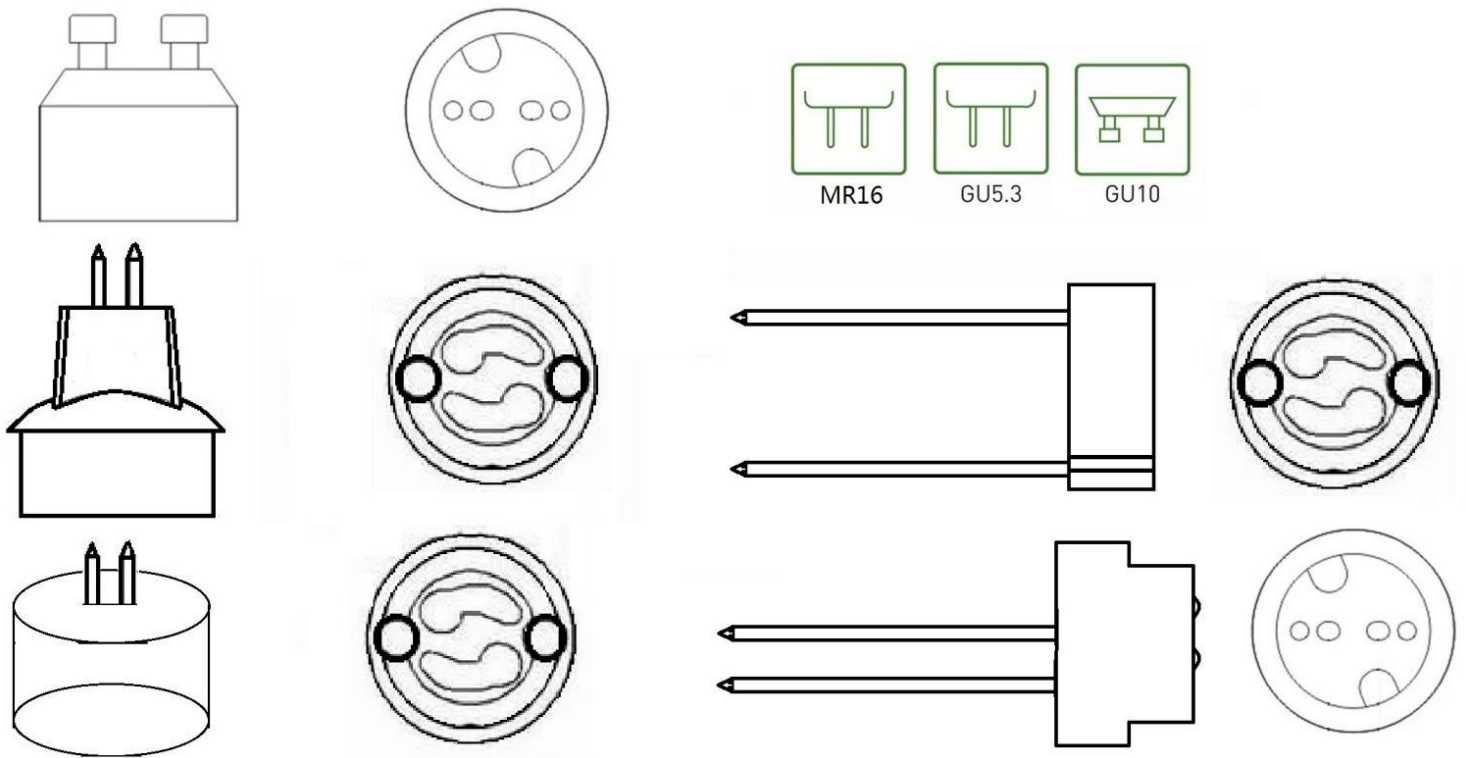

## Features

1. Voltage range: 250V; Electric current: 2A; Power: 100W
2. Ceramic base and silicon wire.(CSA: 0.75 mm<sup>2</sup> , Length: 150mm)
3. Adopter: MR16 & GU5.3 transfer to GU10 to install the lamp
4. Adopter: GU10 transfer to MR16 & GU5.3 to install the lamp
5. Easy to install. One-step installation - Insert the pins of the bulbs into the holes in the middle of the sockets without using any other tools, then screw in the bulb. The bulbs will be held firmly
6. Two year warranty



## LIGHTING FRAMES



## Features

1. Housing frame is suitable for MR16/GU10/GU5.3 bulbs/Halogen Bulb
2. Cut a hole in the ceiling and the sturdy spring loaded wings hold it in place, with spring clips will self-adjust to various wall thickness
3. Installation method: Recessed; Two year warranty
4. Please contact with us for price of the whole lamp fixture and the bulbs together!!

## Product Parameter

Item No	Color	Size(MM)	Material
H-101-1 SQ	WH+MT BK/WH+UV BK CH/BK+UV BK CH	D92*Cut: 75	Dia-casting AL+PC
H-101-2 SQ	WH+UV BK CH	175*92*Cut: 75	Dia-casting AL+PC
H101-3 SQ	WH+UV BK CH	257*92*Cut: 75	Dia-casting AL+PC
H507	WH+SHIG WH/WH+SHIG BK/BK+UV CH	D72*H97* 144	Dia-casting AL+PC
H506	WH+SHIG BK/WH+UV BK CH/BK+DK GY	D72*H97*180	Dia-casting AL+PC
H508A SQ	BK+DK GY/WH+SHIG WH/WH+UV BK CH	72*72*117	Dia-casting AL+PC
H600 RD	BK+SHIG WH/BK+DK GY/BK+UV BK CH	D88*H38*Cut: 75	Dia-casting AL+PC
H800-1 SQ	BK+SHIG BK/SN+UV BK CH	100*100*Cut: 90	Dia-casting AL+PC
H800-2 SQ	BK+SHIG BK/SN+UV BK CH	100*185*Cut: 90*170	Dia-casting AL+PC
H800-3 SQ	BK+SHIG BK/SN+UV BK CH	100*270*Cut: 90*255	Dia-casting AL+PC
H701-1	Matt WH +BK	100*100*H40*Cut: 90	Dia-casting AL
H701-2	Matt WH +BK	100*185*H40*Cut: 90*165	Dia-casting AL
H701-3	Matt WH +BK	100*270*H40*Cut: 90*255	Dia-casting AL
H901-SQ	Sandy WH/Sandy BK	90*90*H45*Cut: 75	Dia-casting AL
H902-RD	Sandy WH/Sandy BK	D93*H45*Cut: 75	Dia-casting AL
H902-2	Sandy WH/Sandy BK	172*90*H45*Cut:165*75	Dia-casting AL
H903	Matt WH	D93*H43*Cut: 85	Iron
0377R	WH+BK/WH+WH/WH+PL BK/WH+CH	D85*Cut: 75	Dia-casting AL+PC
D-501RD	WH+UV BK CH/WH+UV CH/BK+UV CH	D85*H32* Cut 75	Dia-casting AL+PC
D-501SQ	WH+SHIG BK/WH+UV CHROM	85*85*H32*Cut 75	Dia-casting AL+PC
D-502 RD	WH+UV CH/WH+ UV BK CH	D86*H43*Cut 75	Dia-casting AL+PC
600	WH+BK CH/WH+CH	85*85*H36*Cut 75	Dia-casting AL+PC

## Size Diagram

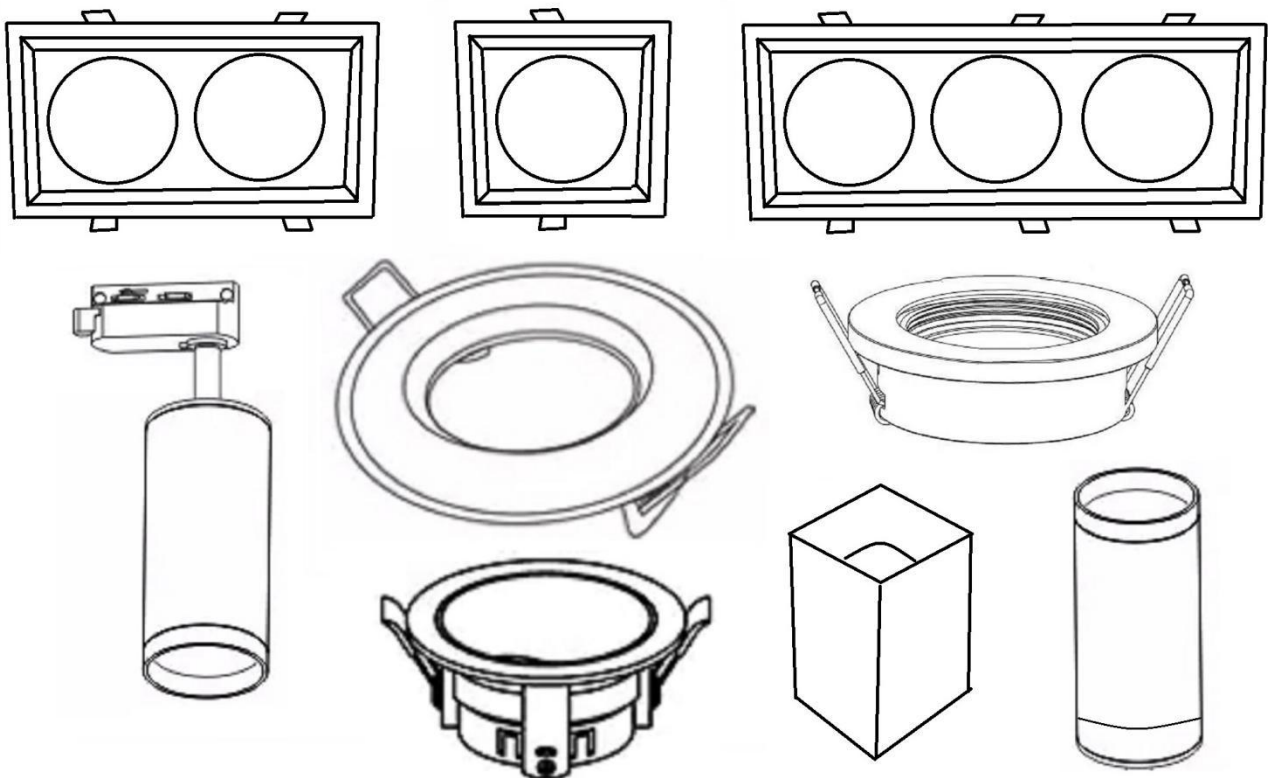



## Installation



**Note: Make sure the power is turned off.**

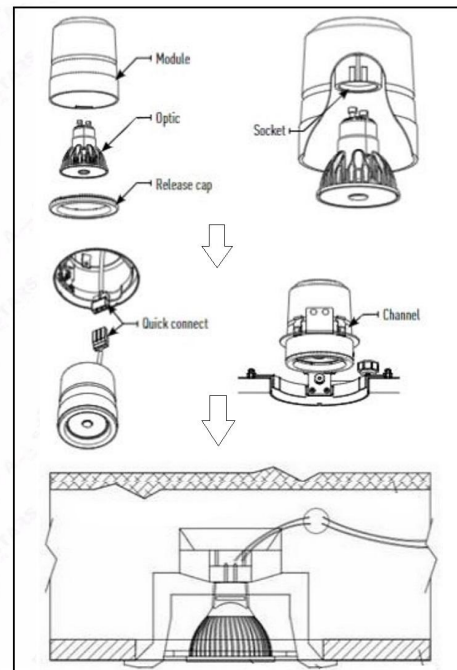
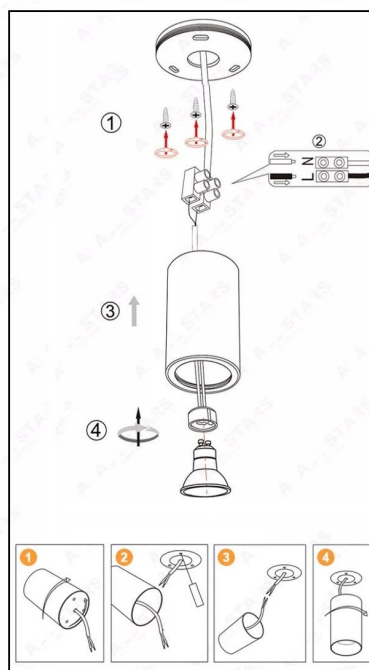
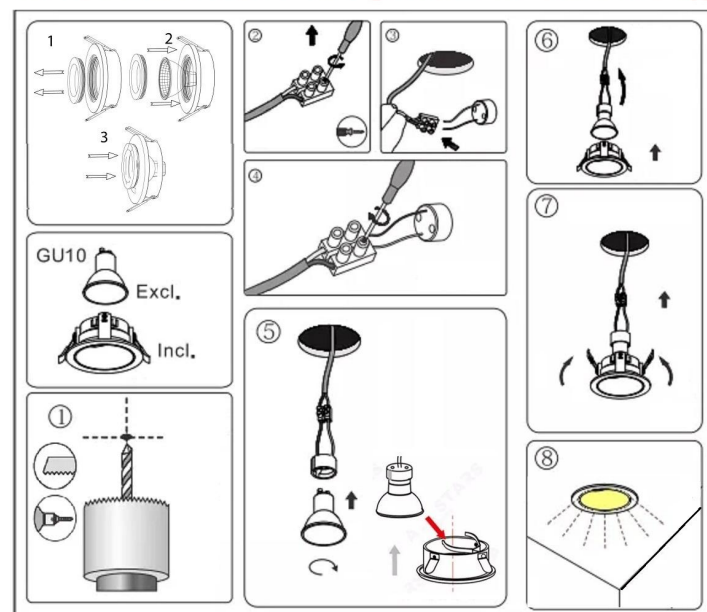

## INSTALLATION DIAGRAM

1. Cut an appropriate hole in the ceiling.

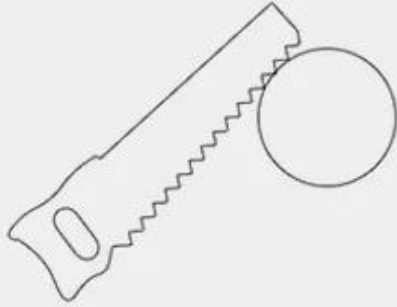

2. Take off the front ring of the downlight frame, put the light source in and install back the front ring.

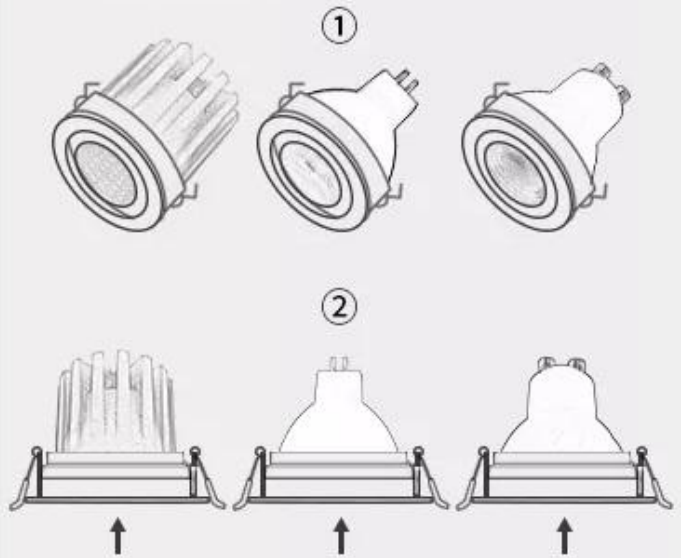

3. Match the light source with the suitable socket or wires.

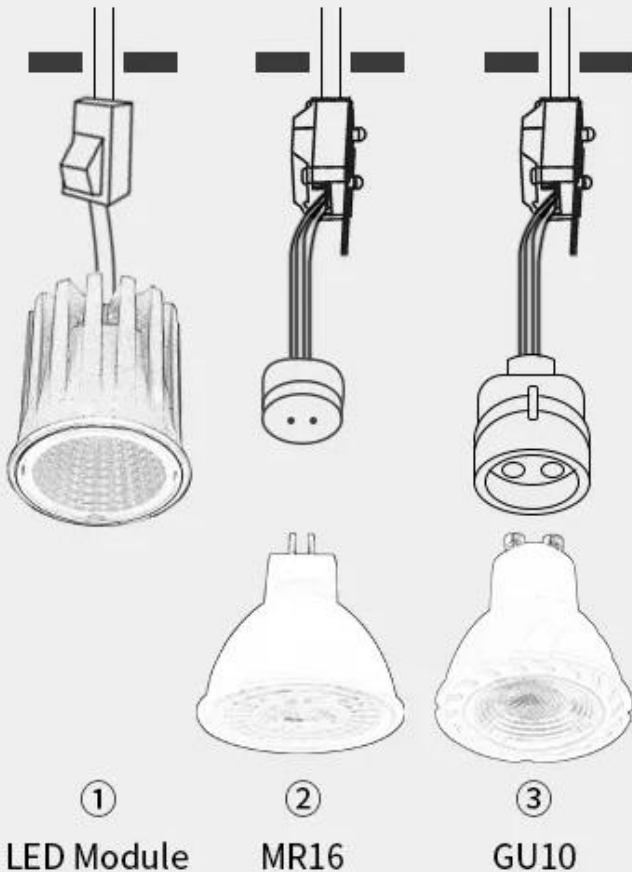

4. Recessed install the downlight into the ceiling by the springs.

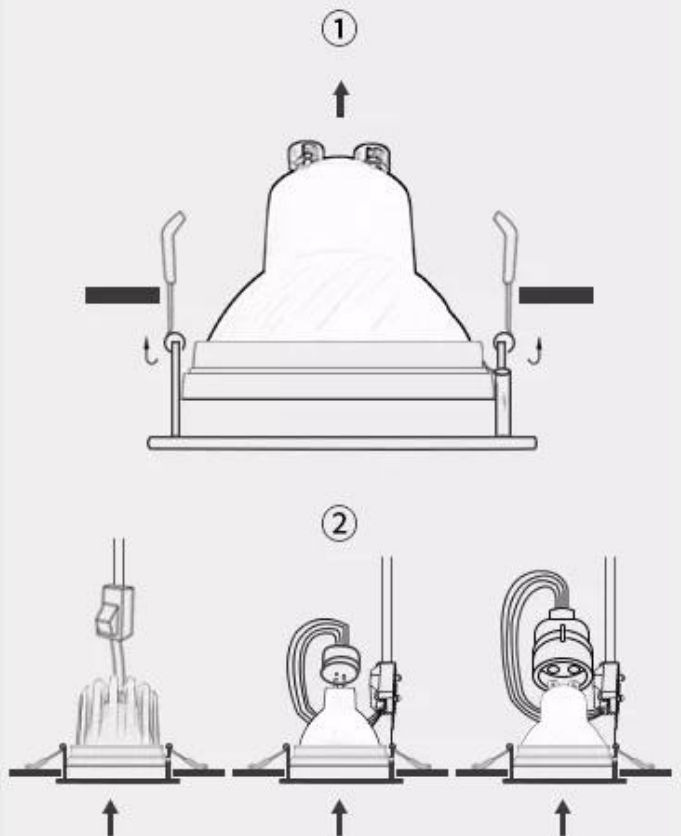

**LAMP INSTALLATION/SERVICING:**

1. Remove trim, then remove module from channel and disconnect quick connect.
2. Rotate release cap by turning counter clockwise.
3. Set cap aside and change lamp.
4. Align lamp base to socket in module, insert lamp then twist and lock.

**MODULE INSTALLATION:**

1. Ensure bracket is at a 0° angle.
2. Connect female quick connect from housing to male quick connect on module.
3. Snap module into channel and confirm module sits parallel to ceiling line and is securely fastened into housing.

**Cautions and instructions**

- A. Never drop or strike the lamp
- B. The lamp should not be disassembled or modified
- C. Never hold the glass tube by hand when installing fixture
- D. Never use with dimming circuit of an emergency light fixture
- E. Never use with closed fixture such as the one shown below

**WARNING!!**

1. To avoid the risk of fire, explosion, or electric shock, this product should be installed, inspected, and maintained by a qualified electrician only, in accordance with all applicable electrical codes.
2. Be certain electrical power is OFF before and during installation and maintenance.
3. The light source contained in this luminaire shall only be replaced by the manufacturer or his service agent or a similar qualified person.
4. Caution, risk of electric shock.
6. IP20 can be used indoor only.
7. Shall be installed out of arms reach.